

AS 5039 security screen guide

AS 5039 testing and compliance information.

V e r s i o n 1 : J u n e 2 0 2 0



Designed and manufactured by Gershwin Pty Ltd
ABN 22 064 102 816
122 Buchanan Road, Banyo QLD 4014
P07 3363 0666 | **E** info@proowlerproof.com.au
proowlerproof.com.au

Table of contents



- 1 [INTRODUCTION](#)
- 2 [AUSTRALIAN STANDARD \(AS\) 5039](#)
- 3 [TESTING](#)
- 4 [TEST REPORTS](#)
- 5 [MANUFACTURING COMPLIANCE](#)
- 6 [PRODUCT OPTIONS / NON COMPLIANCE](#)
- 7 [IDENTIFICATION OF A COMPLIANT SECURITY SCREEN](#)
- 8 [COMPLIANT SECURITY PRODUCTS](#)

AS 5039 security products



Below is a guide explaining what makes a product Australian Standard 5039 Security Screen Doors and Security Window Grilles compliant.

1 Introduction

Doors and window screens are a common additional component in most homes of Australia. There are many forms of screens in Australia and they provide a range of benefits, including:

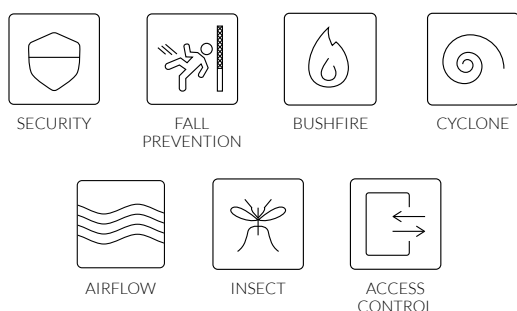

Air circulation / ventilation	Security protection
Insect protection	Cyclone debris protection
Keeping pets out of the home	Pool safety
Fall prevention windows	

In our industry we recognise most screens fall into a few categories, these are:

Insect screens – a light weight mesh product that keeps insects from entering a building.

Fall prevention screens – a screen as defined by the National Construction Code (NCC) that can withstand a 250nM force and designed to prevent smaller children from falling through the window and becoming injured or worse, especially at height.

Security screens – a screen as defined in Australian Standard (AS) 5039 to performance criteria that enhances a building from forced entry.

Non-security screens – any other screen that does not fit any of the above criteria, and does not meet AS 5039.

Security screens in Australia must only be named, advertised and sold as a “Security” screen if they have been tested, passed and conform to the requirements of Australian Standard (AS) 5039. Australian Standard (AS) 5039: Security Screen Doors and Security Window Grilles was developed to provide both the industry and purchasers with specifications covering the general requirements and performance to enhance a building from forced entry.

2 Australian Standards (AS) 5039

WHAT DOES IT COVER?

This Standard specifies the minimum requirements for the performance of all types of hinged and sliding security screen doors, and hinged, sliding, removable, moveable and fixed security window grilles, used primarily in residential situations. It is concerned mainly with resistance to forced entry and does not address the important issues relating to egress in the case of emergency. The document is intended for use by regulatory authorities and all persons concerned with the manufacture, installation and general requirements of security screen doors or window grilles. It gives credibility to the use of the word “security” to ensure suppliers of screens are using it appropriately, so consumers have a level of understanding for what they are purchasing.

3 Testing

AS 5041 METHODS OF TEST

For products to conform to the standard of AS 5039, they must be tested by an accredited laboratory in accordance with Australian Standard (AS) 5041: Methods of test – Security screen doors and window grilles. These tests are broken down depending on the screen type and infill, but consist of:

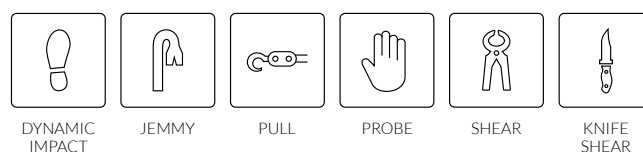

Dynamic Impact Test

Jemmy Test

Pull Test

Probe Test

Shear Test

Knife Shear Test

(from supplier or physically tested independently)

Note: A minimum of 240 hours salt spray corrosion test is required to be submitted to the testing authority in order to pass and comply with AS5039.

AS 5039 security products



Below is a guide explaining what makes a product Australian Standard 5039 Security Screen Doors and Security Window Grilles compliant.

Continued...

3 Testing

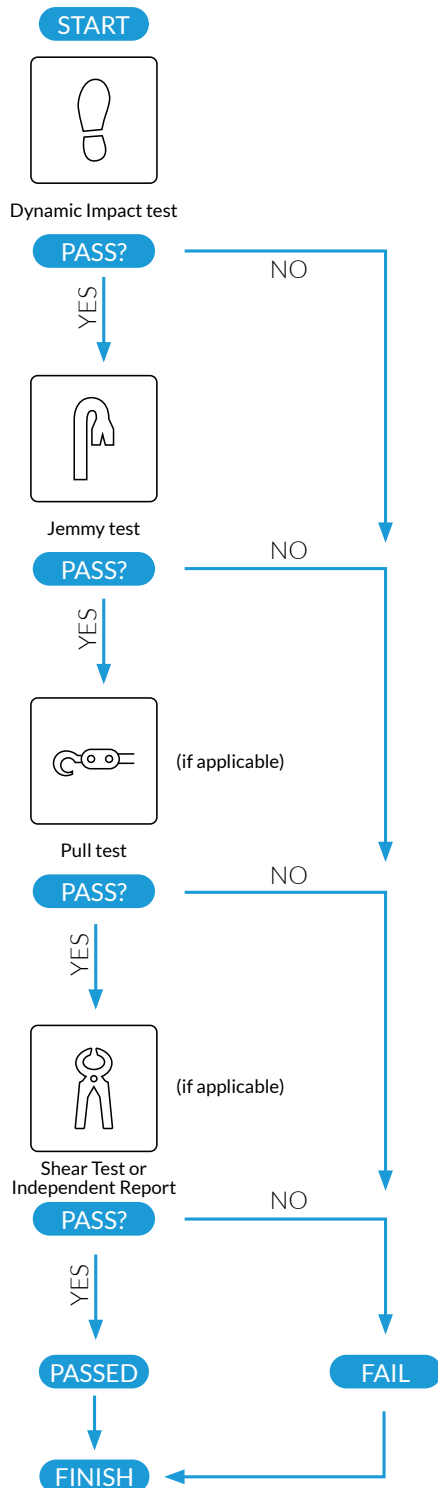

4 Test reports

VERIFYING WHAT IS A SECURITY SCREEN

All products tested by an accredited laboratory will complete a comprehensive test report verifying a pass or fail. The report verifies that a tested and passed screen is deemed "Security" and can therefore be named, advertised and sold as a security screen. There are two ways products can be tested:

Type Tested – this is when a screen is tested to a condition of manufacturing, these same conditions are applied to all other sizes of the same screen product when manufacturing. The same rule applies for the installation conditions. This method has been used by Prowler Proof as our screens are fitted into different situations and systems.

Individual Test – this is when a screen is tested to an exact condition that is not laid out in the type testing, it could be for a specific reason, project, system or the like.

Copies of Prowler Proof [test reports](#) can be obtained from the Prowler Proof website.

5 Manufacturing compliance

BILL OF MATERIALS AND ASSEMBLY METHODS

When manufacturing a screen to security, the screen must be made to the same conditions as the test report for type tested products, or exactly as the test report for individual testing. If any product is manufactured outside of the conditions of the test report, or other options are added, the screen must be named, advertised and sold as a non-security screen.

It is illegal in Australia to sell a product as other than what it is advertised and sold as.

AS 5039 security products

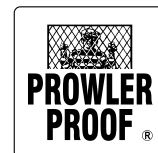

Below is a guide explaining what makes a product Australian Standard 5039 Security Screen Doors and Security Window Grilles compliant.

Continued...

6 Product options / Non compliance

WHAT OPTIONS CHANGE SECURITY TO NON-SECURITY SCREENS

When manufacturing a screen to security it is important to understand what options change a security screen to become non- security (non- compliant). We know that products need to be manufactured with the same conditions as the test samples and reports. However, there can be many options that a consumer wishes to have that impedes a security product. A general guide to untested options that would adversely affect the performance of a security screen, and would change the classification of a security screen to a non-security screen are:

Changed infill material or the addition of a part infill (e.g.: solid bottom panel).

Single point locking.

Pet doors, hopper hatches or port holes.

Different hardware to what has been tested.

Reduced number of hinges.

Reduced number of rollers.

Reduced number of fixings.

Use of a non-tamper-proof fixing in installation.

Any product options that are selected by the environment or consumer must be highlighted to the consumer as making the screen a non-security screen. This way the consumer has full disclosure over what they are selecting and can make an informed decision as to what is important to them when selecting a screen to purchase.

7 Identification of a compliant Security Screen

AS 5039 is the main overarching Australian Standard for our industry. For a security screen to be compliant to this standard it requires that security products be labelled. If you are advertising, manufacturing and selling a product as a security screen then as a minimum, each individual security screen product should identify:

The product as a security screen.

The manufacturer or brand.

The Standard to which the product has passed (AS 5039).

The Standard to which the product has been verified by a method of testing (AS 5041).

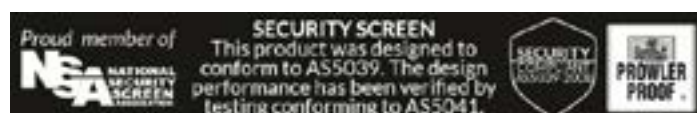

Note: The Competition and Consumer Act 2010 (previously Trade Practices Act 1974) protects consumers from businesses making false or misleading representations. When labelling a product "Security" you MUST be able to verify this using AS5039's requirements.

AS 5039 security products

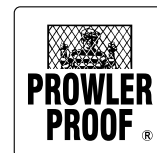

Below is a guide explaining what makes a product Australian Standard 5039 Security Screen Doors and Security Window Grilles compliant.

Continued...

8 Compliant security products

Security Hinge Door

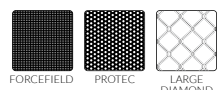

✓ MUST HAVE

1. Triple Point Lock (Lockwood 8654)
2. 5 Pin Cylinder
3. 3 Hinges
4. Install with galvanised screws

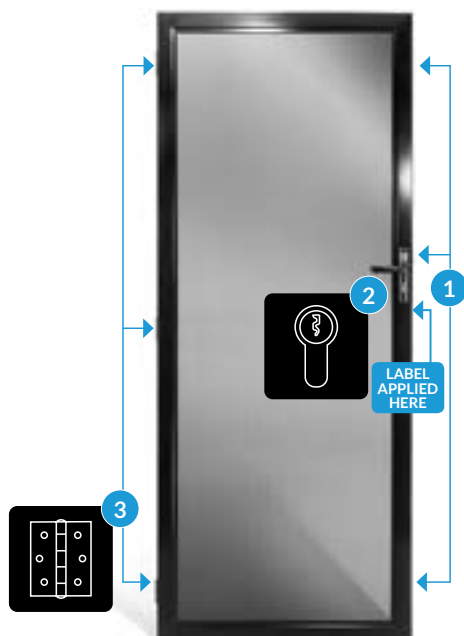

Security Sliding Door

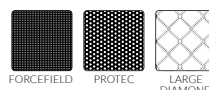

✓ MUST HAVE

1. Triple Point Lock (Lockwood 8653)
2. 5 Pin Cylinder
3. 4 Rollers
4. Heavy Duty or Concealed Interlocks
5. Install with galvanised screws at 300mm centres & 50mm from ends



Security Fixed Window

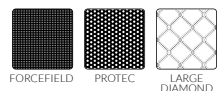

✓ MUST HAVE

1. Install with galvanised screws at 300mm centres & 50mm from ends



Security Hinge Window

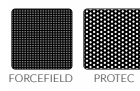

✓ MUST HAVE

1. Install with galvanised screws at 600mm centres & 100mm from ends

